

Soils Map

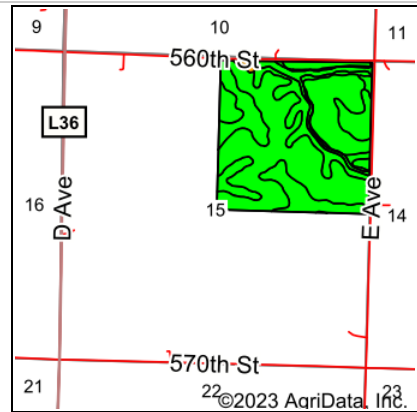

State: **Iowa**
 County: **Cherokee**
 Location: **15-91N-42W**
 Township: **Tilden**
 Acres: **155.85**
 Date: **9/19/2023**

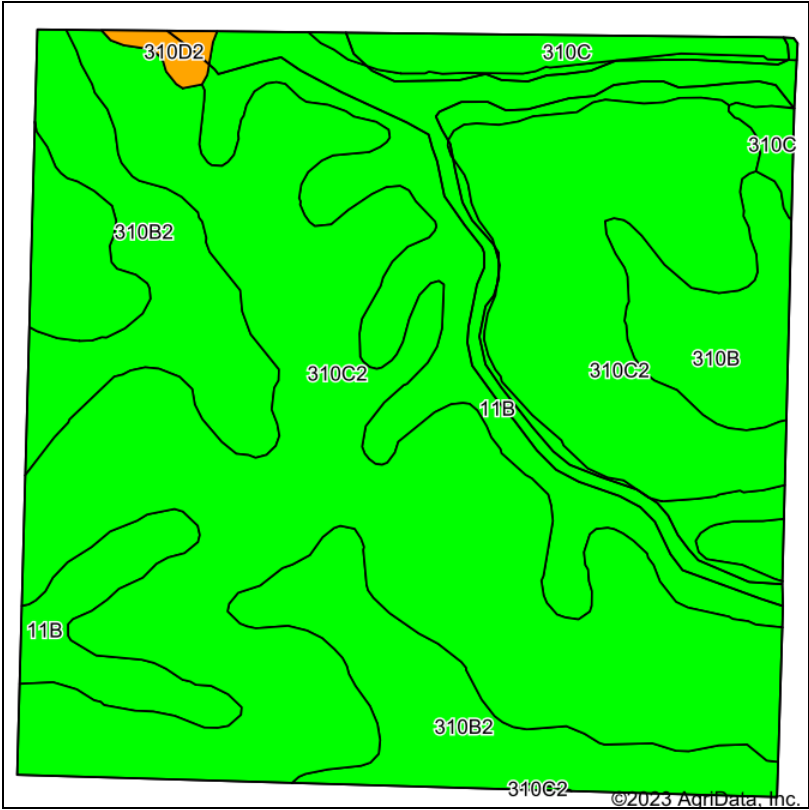

Soils data provided by USDA and NRCS.

Area Symbol: IA035, Soil Area Version: 32										
Code	Soil Description	Acres	Percent of field	CSR2 Legend	Non-Irr Class *c	CSR2**	CSR	*n NCCPI Soybeans		
310C2	Galva silty clay loam, 5 to 9 percent slopes, eroded	89.32	57.3%		IIIe	84	54	65		
11B	Colo-Judson silty clay loams, 0 to 5 percent slopes, occasionally flooded	29.24	18.8%		IIw	80	59	81		
310B2	Galva silty clay loam, 2 to 5 percent slopes, eroded	23.61	15.1%		Ile	90	69	67		
310B	Galva silty clay loam, 2 to 5 percent slopes	8.10	5.2%		Ile	95	71	75		
310C	Galva silty clay loam, 5 to 9 percent slopes	4.65	3.0%		IIIe	87	56	77		
310D2	Galva silty clay loam, 9 to 14 percent slopes, eroded	0.93	0.6%		IIIe	57	44	60		
Weighted Average						2.61	84.7	58.1	*n 69.2	

**IA has updated the CSR values for each county to CSR2.
 *n: The aggregation method is "Weighted Average using all components"
 *c: Using Capabilities Class Dominant Condition Aggregation Method

Soils data provided by USDA and NRCS.